

APPROVED

| REVISIONS | | | | |
|-----------|------|-----------------|----------|----------|
| ZONE | REV. | DESCRIPTION | DATE | APPROVED |
| | A | INITIAL RELEASE | 9/5/2019 | JP |

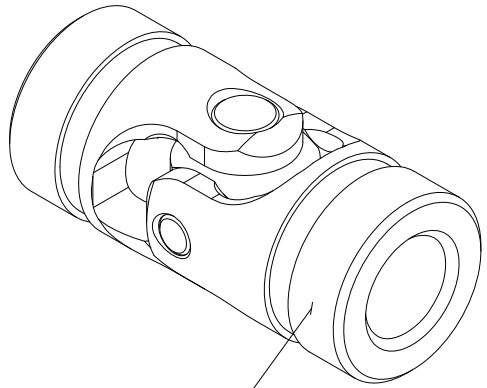

FOR REFERENCE ONLY

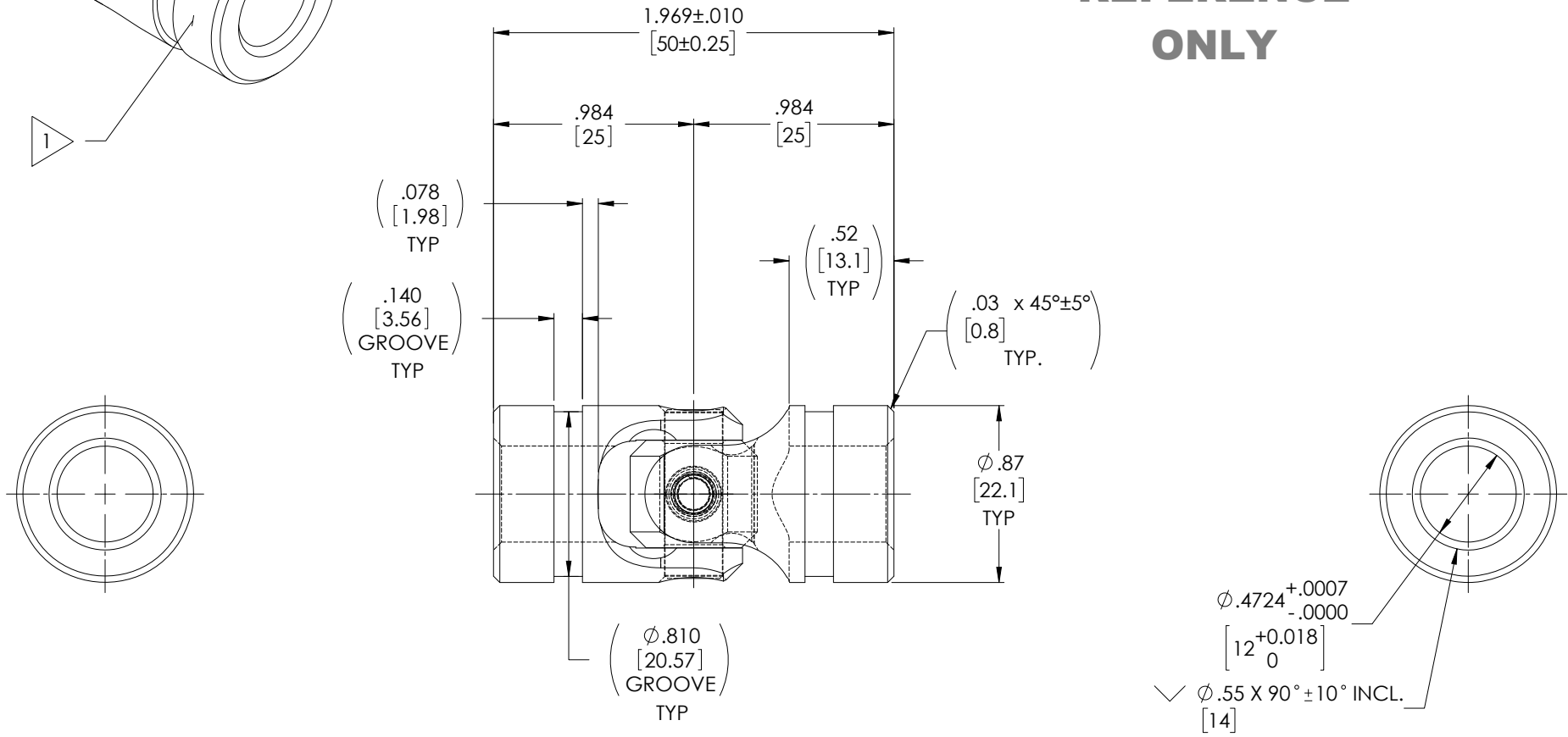

TYPICAL BOTH ENDS

NOTE(s), UNLESS OTHERWISE SPECIFIED.

1 MARK ASSEMBLY w/ "BELDEN" LOGO, PART NUMBER, REVISION LEVEL (IF ANY), DATE OF MANUFACTURE, & BELDEN JOB No.

(2) LUBRICATE U-JOINT w/ LUBRIPLATE # 1200-2, NLGI GRADE 2, AW/EP, LITHIUM GREASE OR EQUIVALENT.

(3) REF., MAXIMUM OPERATING ANGLE: 45°

DO NOT SCALE DRAWING

| | | | | | | | | |
|--|--|--|---|--|--------------------------------|--|---|--|
| UNLESS OTHERWISE SPECIFIED CHAMFER ALL HOLES BREAK ALL SHARP CORNERS DE-BURR ALL FEATURES TURNED SURFACES: $\sqrt{63}$ FRACTIONAL: $\pm 1.0^*$ TWO PLACE DECIMAL: $\pm .015^*$ THREE PLACE DECIMAL: $\pm .005^*$ FOUR PLACE DECIMAL: $\pm .0005^*$ MILLED SURFACES: $\sqrt{125}$ CONCENTRICITY: $.0025^* \text{ T.I.R.}$ | STANDARD TOLERANCES, UNLESS OTHERWISE SPECIFIED DIMENSIONS ARE IN INCHES [mm] | | MATERIAL: ALLOY STEEL | | INITIALS: JP DATE: 05SEP19 | | Belden Universal www.beldenuniversal.com | |
| | HEAT TREAT: SEE DETAIL DRAWINGS | | CHECKED: RNK DATE: 09/06/2019 | | ENG APPR: RNK DATE: 09/16/2019 | | TITLE: ASSEMBLY, UNIVERSAL JOINT | |
| | FINISH: NONE | | QC APPR: | | COMMENTS: | | SIZE: A DWG. NO.: UJ-HD875x12 REV: A | |
| | PROPRIETARY AND CONFIDENTIAL THE INFORMATION CONTAINED IN THIS DRAWING IS THE SOLE PROPERTY OF BELDEN UNIVERSAL. ANY REPRODUCTION IN PART OR AS A WHOLE WITHOUT THE WRITTEN PERMISSION OF BELDEN UNIVERSAL IS PROHIBITED. | | ALL HOLES TO BE LOCATED ON CENTERLINE (C) WITHIN .005" T.I.R. INTERPRET GEOMETRIC TOLERANCES I.A.W. ASME Y14.5 | | SCALE: 2.5:1 WT (Lbs): 0.21 | | SHEET 1 OF 2 | |